



# OSPREY

---

## PILOTHOUSE

QUINCY

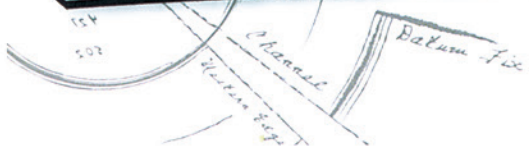

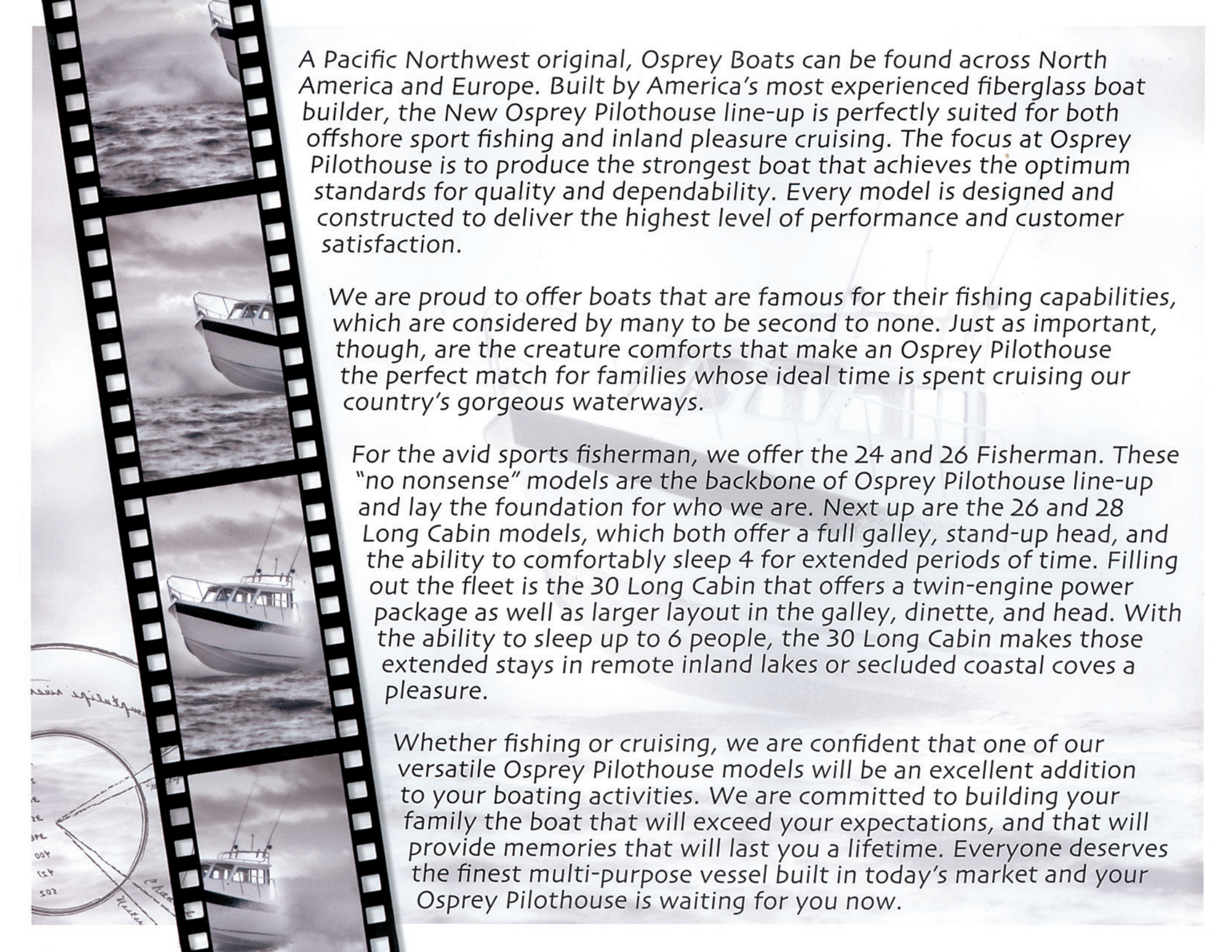

A Pacific Northwest original, Osprey Boats can be found across North America and Europe. Built by America's most experienced fiberglass boat builder, the New Osprey Pilothouse line-up is perfectly suited for both offshore sport fishing and inland pleasure cruising. The focus at Osprey Pilothouse is to produce the strongest boat that achieves the optimum standards for quality and dependability. Every model is designed and constructed to deliver the highest level of performance and customer satisfaction.

We are proud to offer boats that are famous for their fishing capabilities, which are considered by many to be second to none. Just as important, though, are the creature comforts that make an Osprey Pilothouse the perfect match for families whose ideal time is spent cruising our country's gorgeous waterways.

For the avid sports fisherman, we offer the 24 and 26 Fisherman. These "no nonsense" models are the backbone of Osprey Pilothouse line-up and lay the foundation for who we are. Next up are the 26 and 28 Long Cabin models, which both offer a full galley, stand-up head, and the ability to comfortably sleep 4 for extended periods of time. Filling out the fleet is the 30 Long Cabin that offers a twin-engine power package as well as larger layout in the galley, dinette, and head. With the ability to sleep up to 6 people, the 30 Long Cabin makes those extended stays in remote inland lakes or secluded coastal coves a pleasure.

Whether fishing or cruising, we are confident that one of our versatile Osprey Pilothouse models will be an excellent addition to your boating activities. We are committed to building your family the boat that will exceed your expectations, and that will provide memories that will last you a lifetime. Everyone deserves the finest multi-purpose vessel built in today's market and your Osprey Pilothouse is waiting for you now.

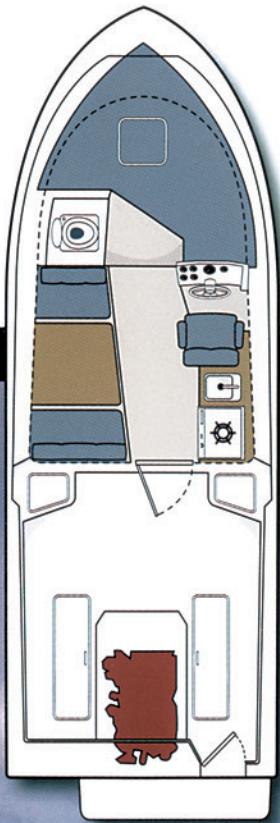

Length Overall 24'

Beam 8' 6"

Cabin Headroom 6' 2"

V-Berth Length 6' 10"

Cabin Size (LxW) 7' x 6' 6"

Cockpit Size (LxW) 7' x 8'

Fuel Capacity 150 gal

Water Capacity 22 gal

Waste Capacity 12 gal

Displacement 5200 lbs (dry)

Power Options:

Single Gas Stern Drive

Single Diesel Stern Drive

Single Outboard

Twin Outboard

# 24 Fisherman



FACTORY 400-98552

FACTORY 400-98552

03161

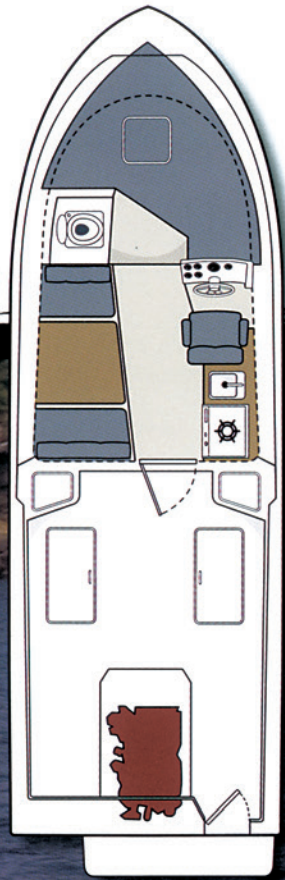

Length Overall 26'

Beam 8' 6"

Cabin Headroom 6'

V-Berth Length 6' 10"

Cabin Size (LxW) 7' x 6' 6" (26 FM)

9' x 6' 6" (26 LC)

Cockpit Size (LxW) 7' x 10' (26 FM)

7' x 8' (26 LC)

Fuel Capacity 150 gal

Water Capacity 22 gal

Waste Capacity 12 gal

Displacement 6000 / 6500 lbs (dry)

Power Options:

Single Gas Stern Drive

Single Diesel Stern Drive

Single Outboard

Twin Outboard



26 Fisherman

FACTORY 400-98552

# 26 Long Cabin



FACTORY 400-98552

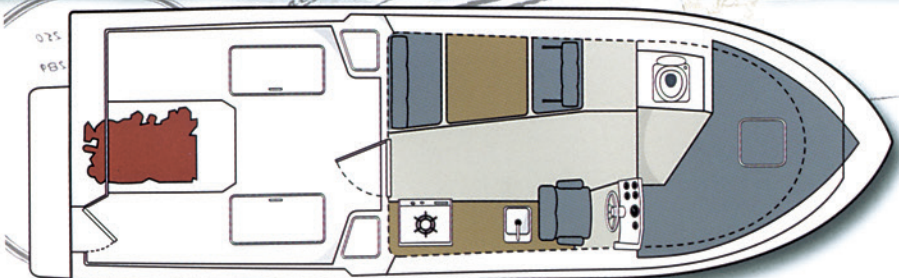

Layout A

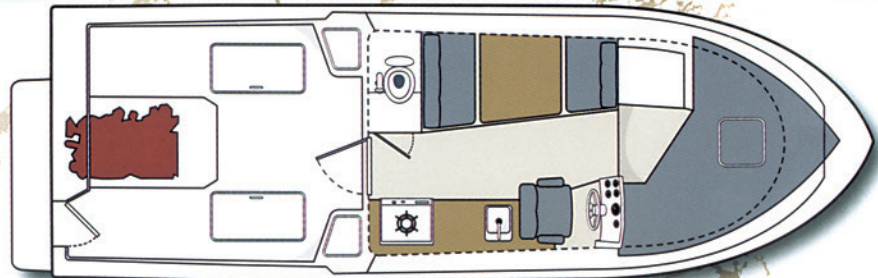

Layout B

OSPREY

|                  |            |                    |                |
|------------------|------------|--------------------|----------------|
| Length Overall   | 28'        | Cockpit Size (LxW) | 8' 8" x 7'     |
| Beam             | 9' 6"      | Fuel Capacity      | 205 gal        |
| Cabin Headroom   | 6' 3"      | Water Capacity     | 35 gal         |
| V-Berth Length   | 7' 8"      | Waste Capacity     | 12 gal         |
| Cabin Size (LxW) | 9' 9" x 7' | Displacement       | 9750 lbs (dry) |

Power Options:  
 Single Gas Stern Drive  
 Twin Gas Stern Drive  
 Single Diesel Stern Drive  
 Twin Diesel Stern Drive  
 Twin Outboard

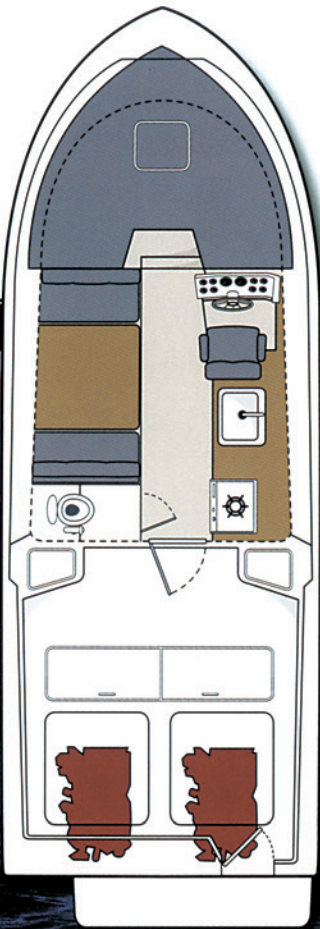

# 28 Long Cabin



FACTORY 400-98552

QUINCY

|                  |             |                    |                  |
|------------------|-------------|--------------------|------------------|
| Length Overall   | 30'         | Cockpit Size (LxW) | 8' x 9' 6"       |
| Beam             | 10'         | Fuel Capacity      | 280 gal          |
| Cabin Headroom   | 6' 4"       | Water Capacity     | 35 gal           |
| V-Berth Length   | 7' 8"       | Waste Capacity     | 12 gal           |
| Cabin Size (LxW) | 11' x 7' 7" | Displacement       | 11,000 lbs (dry) |

- Power Options:
- Single Gas Stern Drive
  - Twin Gas Stern Drive
  - Single Diesel Stern Drive
  - Twin Diesel Stern Drive
  - Twin Outboard

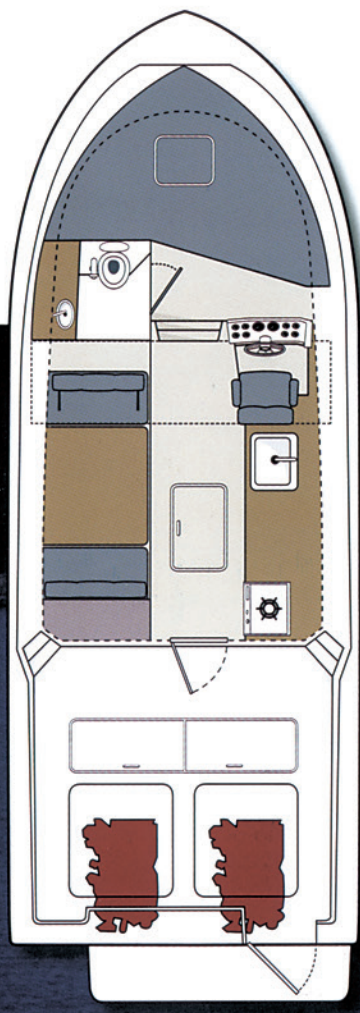

FACTORY 488-98552

# 30 Long Cabin



FACTORY 488-98552

OSPREY

